

order number	lens name
081-325-000-41	Rogonar-S 4.5/75 full metal

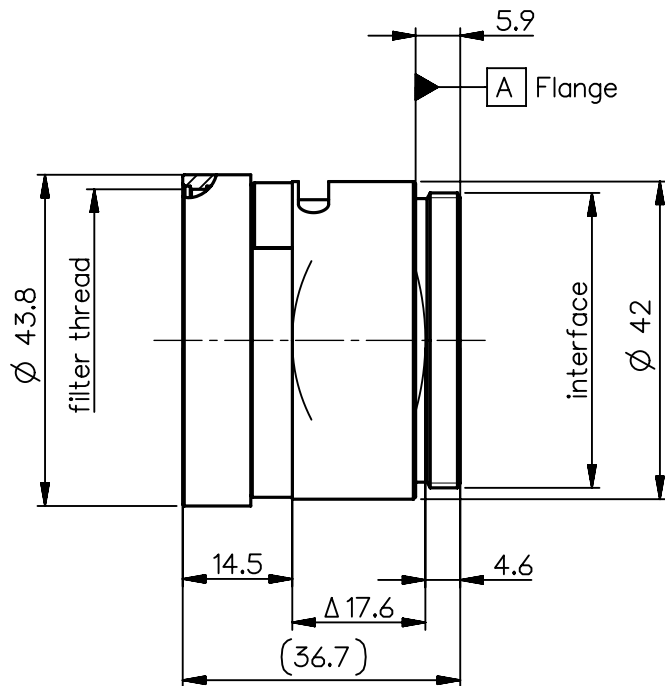

Specification		ON	7105-0001
image circle max. (mm)	44	working distance (mm)	201 - 793
focal length f' (mm)	74.1	interface	M39 x1/26" (Leica)
magnification β' [range]	-0.25 [-0.5 ... -0.1]	filter thread	M40.5 x0.5
spectral range λ (nm)	400 - 750	weight (g)	75

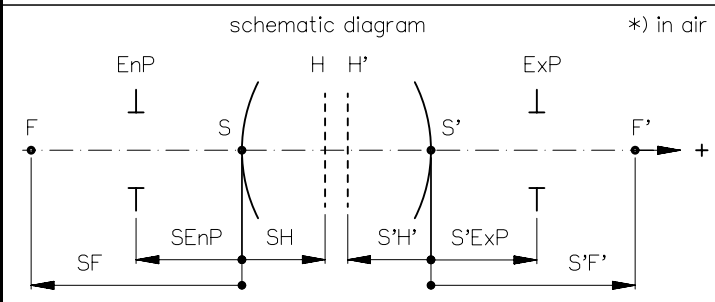

design includes CCD cover glass:		no		
SF (mm)	-67.8	f-stop	Ø EnP	Ø Exp
S'F' (mm) *)	65.0	4.5	16.6	15.9
HH' (mm) *)	0.8	5.6	13.3	12.8
SH (mm)	6.2	8	9.3	9.0
S'H' (mm) *)	-9.1	11	6.8	6.5
SEnP (mm)	9.4	16	4.7	4.5
S'ExP (mm) *)	-6.0	22	3.4	3.3

NX	EU-D		AL-T1A		US-D		US-ML		not export controlled	
							PDM-Status Freigabe		-	
	Rev.	Aenderung	Datum	Freigabe	zul. Abweichung für Mass, Form & Lage	Oberfläche	Maßstab 1:1		Benennung Rogonar-S 4.5/75 full metal	
	a	Neuausg	30.09.16	Bo II			Werkstoff			
				Tolerierung						
				Erster-	Datum	Name			Zeichnungsnummer 0801-325-100-41-0001a	
				stellung	30.09.16	Bo II				
				Prüfung	30.09.16	Stauder				
								Blatt 1		
								von 1		
DIN A 4		Alle Maße in mm, inklusive Oberflächenbehandlung						Ersatz für		

Rogonar-S_4.5/75

MTF at ratio -0.25 f/ 4.5

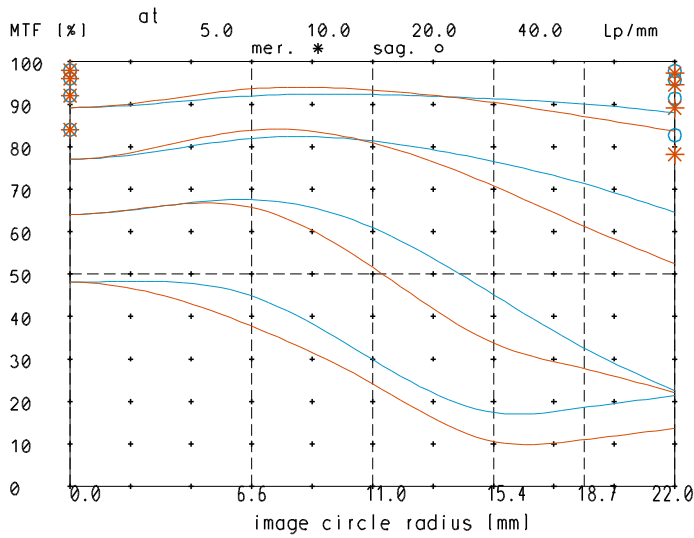

relative light fall-off at ratio -0.25

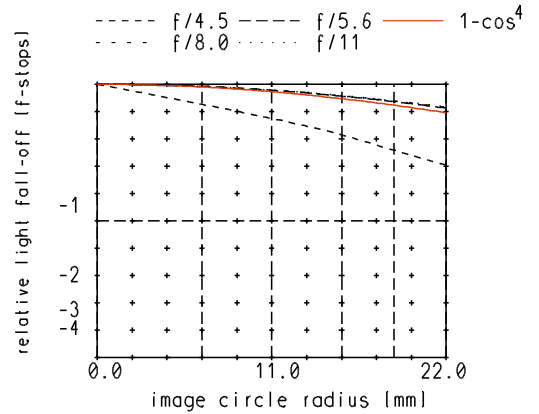

MTF at ratio -0.25 f/ 5.6

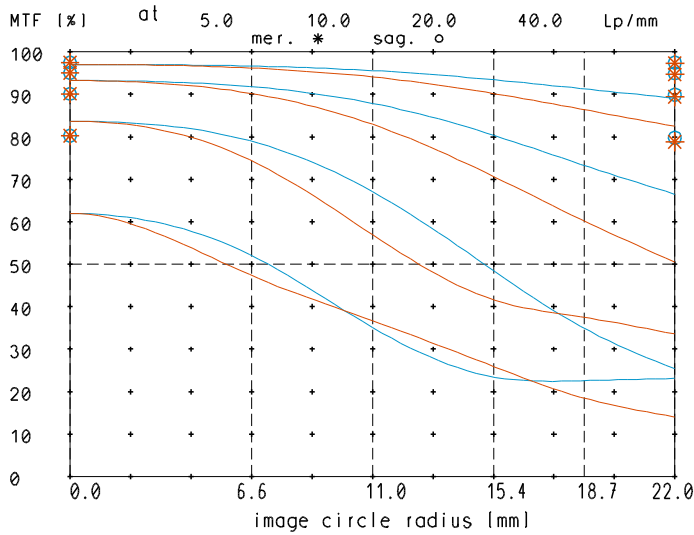

Distortion at ratio -0.1 to -0.5

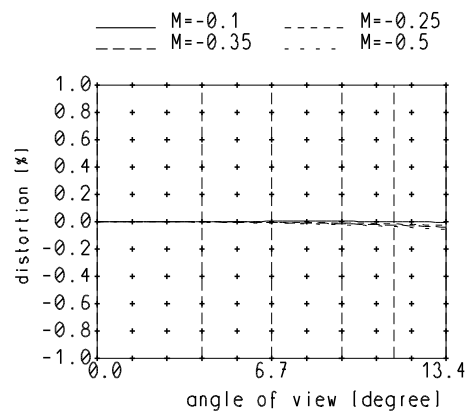

— sagittal. o Diffraction limited value
 — meridional * Diffraction limited value

Longitudinal color aberration at ratio -0.25

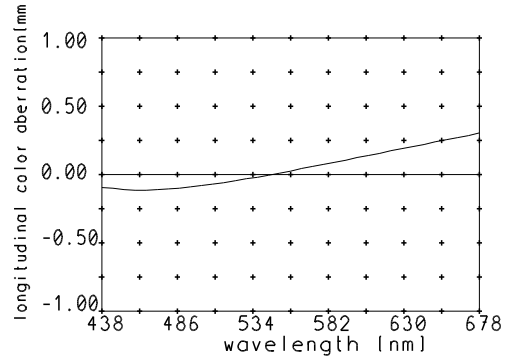

Named frequencies (line pairs/mm) in modular transfer function (MTF) as well as diagrams of relative light fall-off, distortion and longitudinal color aberration refer to film plane.